

Komoka Wellness & Recreation Complex Emergency Action Plan

1 Tunks Lane
 Komoka
 (Middlesex Centre)
 Ontario
 NOL 1R0
 (519) 601-8022





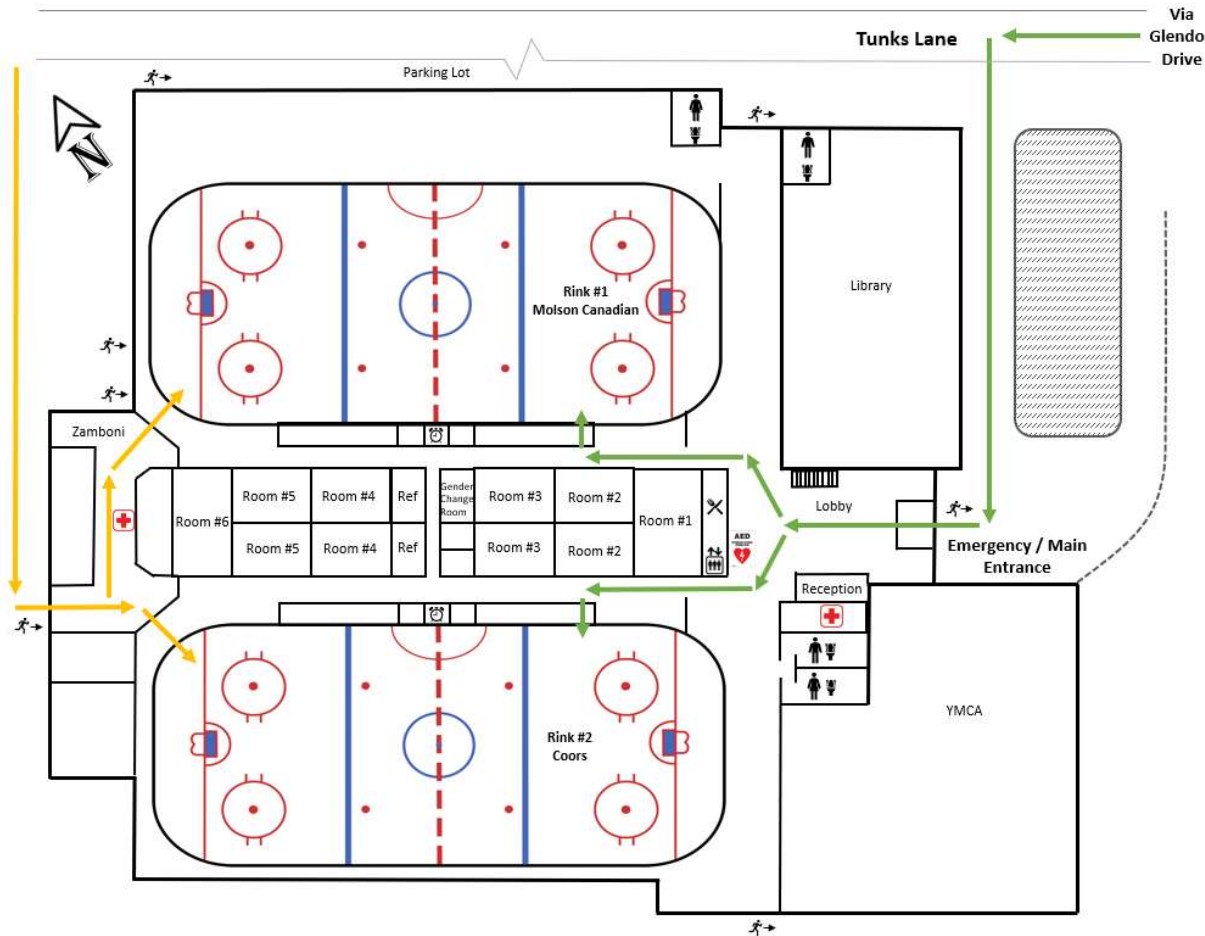

In the case of an emergency the following steps should be taken:

- 1. Charge Person** – The most qualified member of the team staff (Trainer) will care for the injured athlete
- 2. Control Person** – Will control the scene, including keeping players, coaches, referees and parents away from the injured athlete so the Control Person can do their job. The Control Person is also responsible for retrieving the AED and first aid kit.
- 3. Call Person** – will contact Emergency Response (911) and communicate important medical information from the Control Person and provide detailed directions to access the injured athlete.



Once 911 has been activated the Emergency Responders will access Komoka Arena through the front entrance and be directed through the lobby to rink surface. The Charge person will relay medical information to the Emergency Responders while the Call Person and Control Person will work together to keep access and exit points clear for the evacuation of the athlete.

Legend...

- Emergency AED... 
- Emergency Route to Ice... 
- Alternate Emergency Route to Ice... 
- Exits... 
- First Aid... 